

## 36263 LARATA EL-10 B

Wall & ceiling lighting fitting

5905339362636

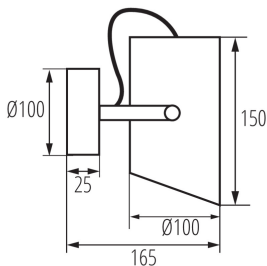

Kanlux LARATA EL is a single-point spot that can be used as ceiling lighting, but also as wall lighting. The housing is made of steel with attention to every detail. LARATA lamps are premium products that meet the requirements of even the greatest aesthetes.

### GENERAL DATA:

**Colour:** black

**Place of assembly:** wall mounted, ceiling mounted

**Place of application:** Indoors

**Minimum distance from the illuminated object:** 0,5m

**Length [mm]:** 165

**Width [mm]:** 100

**Height [mm]:** 150

### TECHNICAL DATA:

**Rated voltage [V]:** 220-240 AC

**Rated frequency [Hz]:** 50

**Maximum power [W]:** max 5

**Class of protection against electric shock:** I

**Light source included:** no

**Cap:** E27

**Ambient temperature range to which the product can be exposed:** 5÷25

**Enclosure material:** Metal

**Connection type:** Bolt terminal block

**Range of sections of wires used [mm<sup>2</sup>]:** 1÷2,5

**The fixture is movable horizontally [°]:** 330

**The fixture is movable vertically [°]:** 100

**IP class:** 20

### LOGISTIC DATA:

**Packaging method:** 6

**Number of units in the secondary packaging:** 1

**Number of units in the packaging:** 6

**Net unit weight [g]:** 504

**Grammage [g]:** 655

**Length of a unit pack [cm]:** 18

**Width of a unit pack [cm]:** 13.5

**Height of a unit pack [cm]:** 16.5

**Weight of a cardboard box [kg]:** 3.93

**Width of a cardboard box [cm]:** 19.5

**Height of a cardboard box [cm]:** 35

**Length of a cardboard box [cm]:** 42

**Volume of a cardboard box [m<sup>3</sup>]:** 0.028665

Wall & ceiling lighting fitting

