

## 01440 ADI 350 1x3W

CC power supply unit

5905339014405

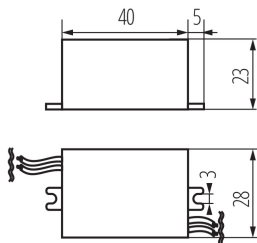

Kanlux ADI electronic power supply unit - with maximum permissible temperature of casing 75°C and current stabilization 350mA DC - has an embedded protection against short circuits and against overload as well as a thermal protection turning off the power supply unit when the temperature of 110°C is exceeded.

### GENERAL DATA:

**Colour:** white

**Place of application:** Indoors

**Possibility of installation on a normally flammable surface:** yes

**The product is not suitable to be covered with a heat-insulating material:** yes

**Length [mm]:** 28

**Height [mm]:** 23

**Wire length [m]:** 0.1

### TECHNICAL DATA:

**Rated voltage [V]:** 220-240 AC

**Rated frequency [Hz]:** 50/60

**Maximum power [W]:** 1-3

**Class of protection against electric shock:** II

**Material:** plastic

**Ambient temperature range to which the product can be exposed:** 5÷25

**Connection type:** Free cable ends

**Wire diameter [mm<sup>2</sup>]:** 0.75

**Supply-cord type:** direct current

**Overload protection:** yes

**Thermal protection:** 110°C

**Short-circuit protection:** yes

**Maximum temperature Ta [°C]:** 50

**Input voltage - PRI [V]:** 220-240

**Output voltage - SEC [V]:** 0,5-10 DC

**Output current - sec [ma]:** 350

**IP class:** 20

**Tc [°C]:** 85

### LOGISTIC DATA:

**Unit of measurement:** unit

**Packaging method:** 100

**Number of units in the packaging:** 100

**Net unit weight [g]:** 42

**Grammage [g]:** 54

CC power supply unit

**Length of a unit pack [cm]:** 4  
**Width of a unit pack [cm]:** 3  
**Height of a unit pack [cm]:** 6.5  
**Weight of a cardboard box [kg]:** 5.4  
**Width of a cardboard box [cm]:** 17  
**Height of a cardboard box [cm]:** 18  
**Length of a cardboard box [cm] :** 43  
**Volume of a cardboard box [m<sup>3</sup>]:** 0.013158

### **ADDITIONAL INFORMATION:**

- ADI 350 1-3W current stabilization 350mA DC
- ADI 700 1x3W current stabilization 700mA DC
- Maximum permissible housing temperature 75°C
- Thermal protection shutting down the power supply after the temperature exceeds 110°C
- Built-in circuit and overload protection